

Project Specific Notes:

- .032" Aluminum
- .040" Aluminum (ES-1)
- .050" Aluminum
- .063" Aluminum
- 22 g. Al-Zn Steel
- 24 g. Al-Zn Steel (ES-1)

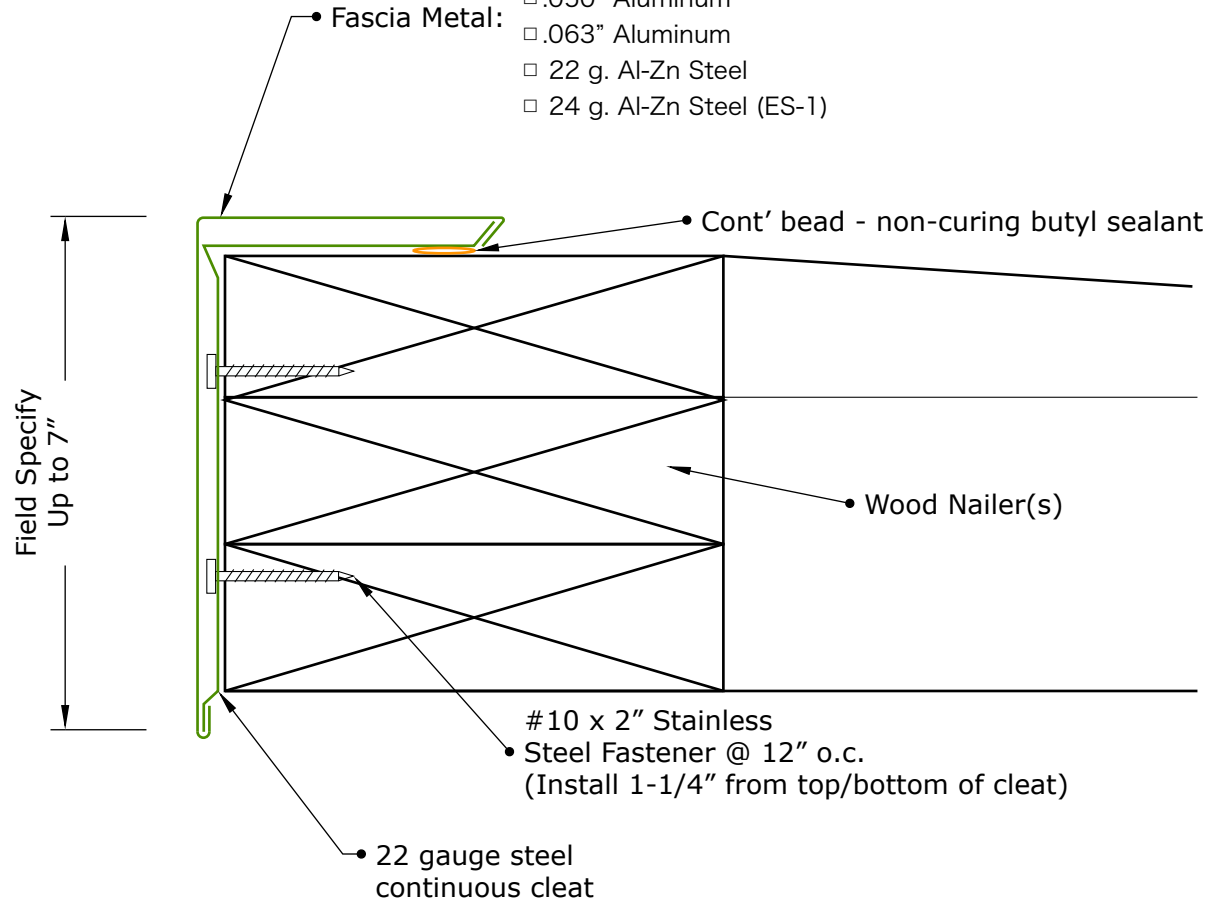

FormTight
 Architectural Metal Systems
 info@formtightmetals.com
 FormTight of Ohio, Inc.

Project:		Product Name: FormSnap Fascia - 2P		FTAM Code: FSF-2P
Contractor:		Description: 2 piece - brake formed "snap-type" fascia in Galvalume™ or Aluminum based sheet metal with factory applied paint finish. Engineered to ES-1 Certification wind resistance and suitable for all single-ply commercial roof edge applications subject to manufacturer's installation guidelines.		
Approved By:	Date:	Scale: NTS		